

Crank

What is a Crank?

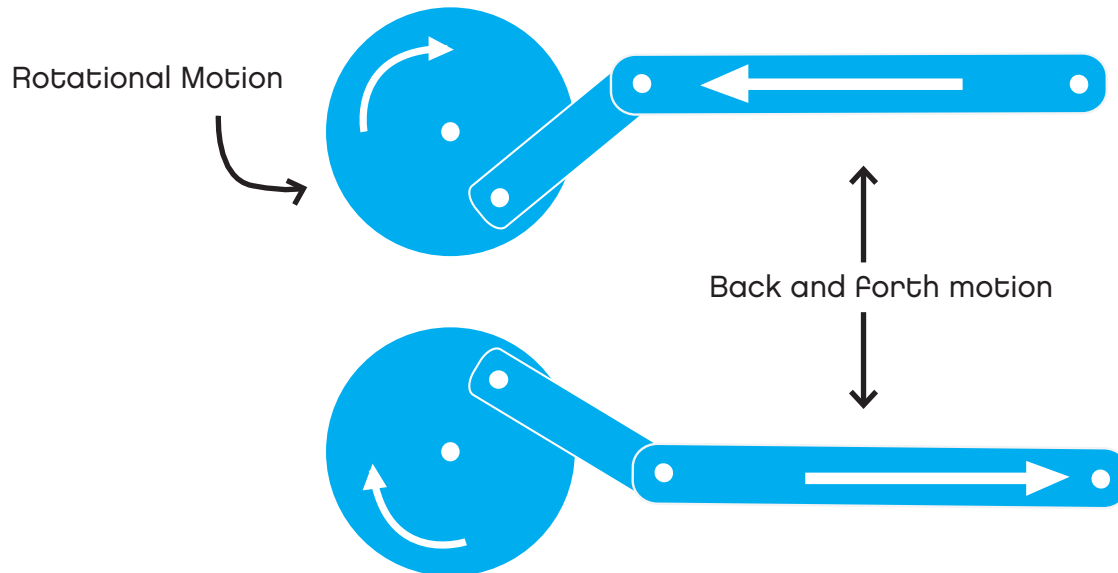

Crank is used to convert the rotational motion of a motor to a back and forth motion (called as a reciprocal motion). Sometimes the reverse is also done - i.e. the back-and-forth motion of a crank is used to turn the wheel of the motor.

There are several examples of cranks:

- a) Steam engine wheels
- b) Electric Toothbrush
- c) Crankshaft of a car
- d) The pedals on a bike that move the wheels.
- e) Pencil sharpener